

Flo-Tite, Inc.

Valves & Controls

2 PC Full Port Threaded End Ball Valves

PERFORMANCE SERIES

Models:

T75-SS

T75-CS

Stainless Steel 316
Carbon Steel WCB
Rating: 1500 WOG
150 PSI Steam Rated
SIZES: 1/4" thru 3"



I-SO Mount

DESIGN FEATURES:

- Safety Locking Handle Lever & Oval Type
- Blowout Proof Stem
- Self-Adjusting V-Ring Stem Packing
- Designed for Actuator and Accessory Mounting
- Meets Federal Specification WWV-35B, Type II, Class C, Style 3
- NACE MR0175-90
- Vacuum Service to 20 microns
- Live Loaded Stem Design
- Optional Seal Welded Body
- I-SO-Mount Type Actuator Pad
- Secondary Containment
- High Temp. TFM Seating-Standard
- Temperature $-50\text{ }^{\circ}\text{F}$ to $+550\text{ }^{\circ}\text{F}$
- All Stainless Steel Valves are Solution Annealed
- All Body Casting are Marked with a Foundry Heat Lot Number for Full Traceability
- Anti-Static Standard
- 1500 WOG
- **3" Size Offers**
- 2PC Bolted Body Design

Ideal Design for Ease of Automation, I-SO-Mount Interchanges with Both 3-PC and Flanged End Models. F150 / F300

DESIGN & TECHNICAL DATA

BILL OF MATERIALS:

NO.	PART NAME	MATERIAL T75-SS	Q'TY	MATERIAL T75-CS
1	BODY	ASTM A351 GR.CF8M	1	ASTM A351 GR.CF8M
2	END CAP	ASTM A351 GR.CF8M	1	ASTM A351 GR.CF8M
3	BALL	ASTM A351 GR.CF8M	1	ASTM A351 GR.CF8M
4	SEAT *	TFM - Super TEK	2	TFM - Super TEK
5	STEM	ASTM A276 TYPE316	1	ASTM A276 TYPE316
6	BODY SEAL *	TFM	1	TFM
10	ANTI-STATIC	SS304	2	SS304
11	THRUST BEARING *	50% PTFE+50% 316	1	50% PTFE+50% 316
12	THRUST WASHER *	TFM - Super TEK	1	TFM - Super TEK
14	STEM PACKING *	TFM - Super TEK	4	TFM - Super TEK
15	PACKING GLAND	SS-304	1	SS-304
18	BELLEVILLE WASHER	SS-301	2	SS-3
19	LOCK WASHER	SS-304	1	SS-3
23	STOP SET SLEEVE	SS-304	1	SS-3
24	STOP BOLT	SS-304	1	SS-3
25	HANDLE	SS-304	1	SS-3
26	THIN NUT	SS-304	2	SS-3
28	HANDLE SLEEVE	VINYL PLASTISOL	1	VINYL
29	LOCKING DEVICE	SS-304	1	SS-3

• Recommended Spare Parts

PRESSURE & TEMPERATURE DATA

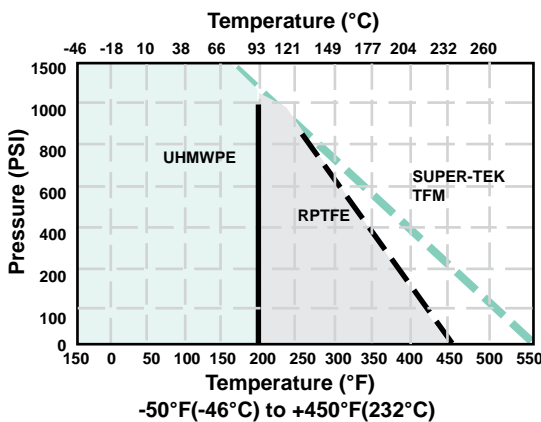

MODEL T75-SS

Valve Components

- Live Loaded Stem Design
- All Valves 100% air tested, in accordance with MSS-SP-72 under water, at 100 PSI in open and closed positions
- Shell wall ANSI B1634
- Thread End Connections meet ANSI B1-20-1 NPT

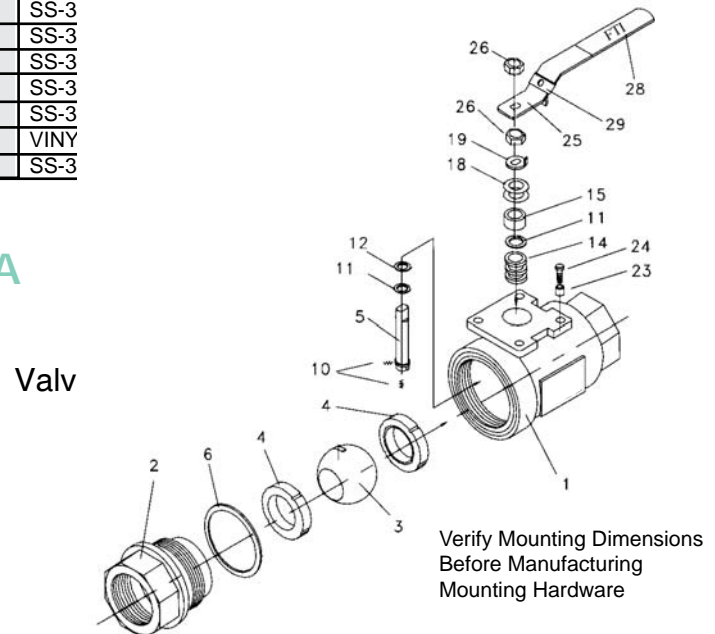

DIMENSIONS AND WEIGHTS:

SIZE	A	B	C	D	CV	TORQUE (in-lbs)	WEIGHT (lbs)
1/2"	2.56	0.59	2.52	5.87	15	60	1.01
3/4"	2.99	1.79	2.80	5.87	38	80	1.54
1"	3.47	0.98	3.11	7.87	65	95	2.56
1-1/4"	3.82	1.26	3.66	7.87	118	191	3.97
1-1/2"	4.33	1.51	3.94	9.69	195	312	5.56
2"	5.28	2.00	4.25	10.2	320	385	8.86
2-1/2"	6.18	2.56	5.00	9.65	410	478	14.3
3"	7.52	2.99	5.71	5.98	640	805	25.3

MOUNTING DIMENSIONS:

SIZE	M	L	K	ØP	ØS	W
1/2"	0.250	0.650	0.354	0.37	1.654	#10-24UNC/M5
3/4"	0.250	0.650	0.354	0.37	1.654	#10-24UNC/M5
1"	0.315	0.866	0.551	0.43	1.969	1/4-20UNC/M6
1-1/4"	0.315	0.787	0.551	0.43	1.969	1/4-20UNC/M6
1-1/2"	0.374	1.024	0.591	0.62	2.756	5/16-18UNC/M8
2"	0.374	1.024	0.591	0.62	2.756	5/16-18UNC/M8
2-1/2"	0.472	1.142	0.748	0.75	4.016	5/16-18UNC/M8
3"	0.469	1.280	0.880	0.75	4.016	5/16-18UNC/M8

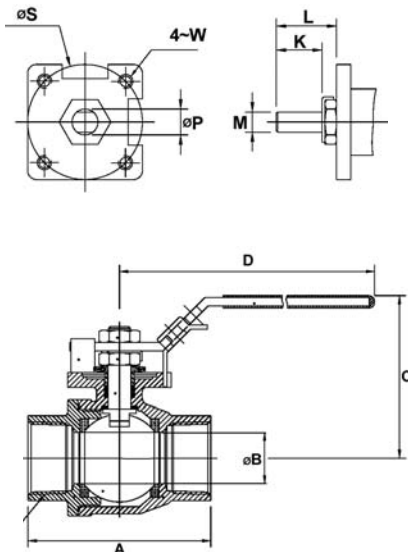

This brochure is general in nature and manufacturer reserves the right to alter dimensions, materials or to make design improvements.