



## HIGH PRESSURE - Seal Welded Ball Valve

### FloTron-II Series

#### Models:

S6000 - SS

S6000 - CS

Threaded End Connections

6000 PSI WOG

Size: 1/4" - 2"

Full Bore 1/4" - 1 1/2"

2" Standard Bore



#### Design Features:

- Seal Welded Body
- Blow-out Proof Stem Design
- NACE MR0175-90
- Heavy Duty, Rugged Construction
- Lockable Handles
- API 507-4 Fire Safe
- Anti-Static Ground
- Casting Traceability
- Actuator Mounting Pad

#### Seal Welded Design

Eliminating the possibility of body tail piece unthreading. Eliminating any possible leakage at body joints - safe, sure pressure containment.

Automatic Welding equipment is used for welding body joints. The welding width is always uniform and the weld penetration is consistent. Our equipment maintains a consistent water flow inside the valve, this assures a safe temperature which prevents damage to all valve seats and seals.

*Ideal for Hydraulic, Petrochemical and many other industries that required tight pressure valves*

[www.flotite.com](http://www.flotite.com)

**DESIGN AND TECHNICAL DATA**

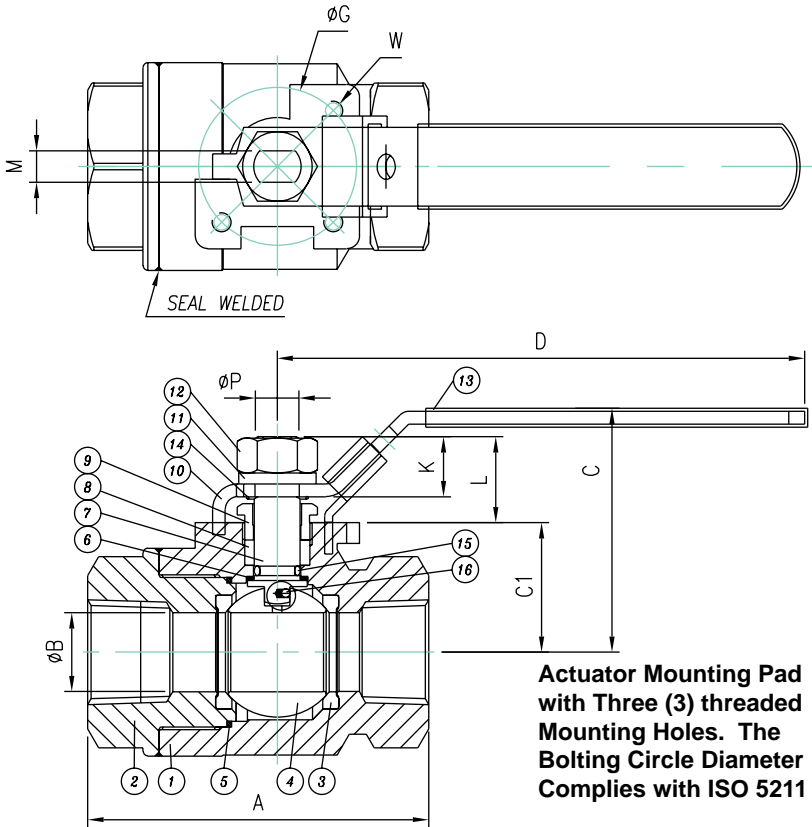

**Model:**

**Carbon Steel: S6000-CS**  
**Stainless Steel: S6000-SS**

**BILL OF MATERIALS:**

Item	Part Name	S6000-SS	S6000-CS
1	Body	A351 CF8M	A216 WCB
2	End Cap	A351 CF8M	A216 WCB
3	Seat	Delrin	Delrin
4	Ball	SS316	SS304
5	Gasket	Graphite	Graphite
6	Thrust Washer #	PTFE	PTFE
7	Stem	A276 316	A276 304
8	Stem Packing #	Graphite	Graphite
9	Gland	SS304	SS304
10	Handle	SS304	Zinc Plated C.S.
11	Handle Washer	SS304	SS304
12	Handle Nut	SS304	SS304
13	Handle Cover	PVC	PVC
14	Anti-Static Spring	SS301	SS301
15	O-Ring #	Viton	Viton
16	Anti-Static Device	SS316	SS304

# Parts included in the repair kits

Conform to:

- API STANDARD 6D
- ANSI B1.20.1 Threaded End NPT
- ANSI Class 2500 (6000 WOG)
- Fire Safe Testing API607

**6000 Psi TESTING:**

**Test Pressure: Shell 9,000 Psi**  
**Seat 6,000 Psi**

**FIRE-SAFE DESIGN FEATURE:**

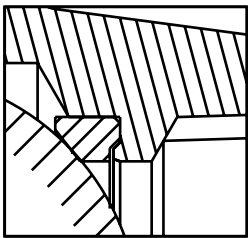

FIRE SAFE Flo-Tite's Model S6000 valves are supplied as standard with graphite stem packing and body seal. Valves are certified fire safe. In the event of a fire, after heat destroys the primary resilient seat, the ball makes contact with the secondary metal seat, forming a secure seal. The graphite body seal prevents external leakage. The graphite live-loaded stem packing prevents stem leakage. All valves have anti-static devices as standard, grounding ball and stem to body.

**DIMENSIONS AND WEIGHTS:**

SIZE	A	B	C	C1	D	G	K	L	M	P	W	Cv	Torque In-Lb	Weight Lbs
1/4"	2.80	0.37	2.34	0.96	4.25	1.42	0.31	0.50	0.20	0.31	M5	7	195	1.19
3/8"	2.80	0.37	2.34	0.96	4.25	1.42	0.31	0.50	0.20	0.31	M5	8	195	1.15
1/2"	3.19	0.49	2.34	0.96	4.25	1.42	0.31	0.50	0.20	0.31	M5	10	233	1.50
3/4"	3.78	0.79	2.50	1.24	5.16	1.65	0.55	0.83	0.28	0.39	M5	35	404	2.76
1"	4.25	0.98	3.00	1.61	6.57	1.97	0.75	1.06	0.39	0.55	M6	68	825	4.87
1-1/4"	4.72	1.26	3.19	1.81	6.57	1.97	0.75	1.06	0.39	0.55	M6	110	860	7.41
1-1/2"	5.12	1.50	4.30	2.40	8.66	2.76	1.14	1.56	0.47	0.79	M8	155	997	12.1
*2"	5.91	1.50	4.30	2.40	8.66	2.76	1.14	1.56	0.47	0.79	M8	155	1490	14.7

\* 2" size is standard port design

**PRESSURE AND TEMPERATURE CHART:**

