

Flo-Tite, Inc.

Valves & Controls

2PC Full Bore Econical Ball Valve

2PC ECONOFLO SERIES

Model : T80SS

1000 WOG / 150 SWP

316 Stainless Steel

Optional Carbon Steel

Temperature Range:

-20 °F to 450 °F

-46 °C to + 232 °C

Size Range:

1/4" - 2"

Threaded Ends



DESIGN FEATURES

- Full Port - Straight through flow minimizes pressure drop and prolongs valve life
- Internal Entry Blow-out Proof Stem
- Locking Handle - Standard on all valves meets OSPA 1910.147
- Adjustable V-Ring Stem Packing
- Bubble Tight - Zero Leakage
- Actuator Mounting Pad
- Blow - out Proof stem
- Investment cast improves dimensional control and reduces porosity
- 2PC Econoflo Series is an Ideal General purpose stainless steel valve, meeting plant - wide applications

Econoflo Series offers exceptional economy and proven performance

www.flotite.com

T80SS Full Port Ball Valve Design & Technical Data

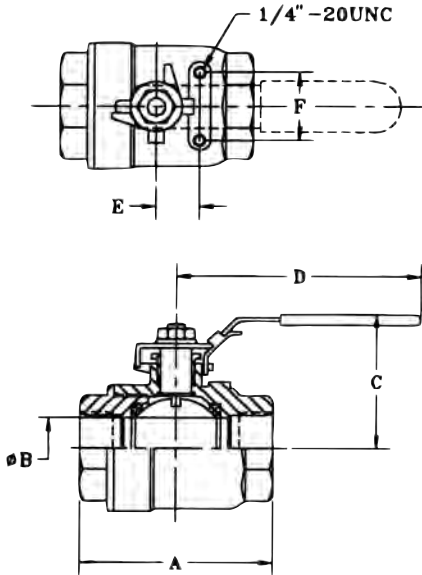

DIMENSIONS AND WEIGHTS:

SIZE		1/4"	3/8"	1/2"	3/4"	1"	1 1/4"	1 1/2"	2"	2 1/2"	3"
A	in	2.20	2.20	2.52	2.95	3.35	3.86	4.17	4.80	6.38	7.01
	mm	56	56	64	75	85	98	106	122	162	178
ΦB	in	0.43	0.47	0.59	0.79	0.98	1.26	1.50	1.97	2.56	3.07
	mm	11	12	15	20	25	25	32	50	65	78
C	in	1.89	1.89	2.24	2.36	2.80	3.13	3.46	3.86	4.88	5.41
	mm	48	48	57	60	71	79.5	88	98	124	137.5
D	in	3.54	3.54	3.94	4.53	5.51	5.51	7.09	7.48	8.66	9.45
	mm	90	90	100	115	140	140	180	190	220	240
CV		6	7	10	25	35	46	80	110	310	360
Torque (in-lbf)		36	36	65	80	120	235	290	370	685	810
Weight (lbs)		0.66	0.66	0.79	1.28	2.29	3.39	4.97	8.36	15.0	25.5

All valves 100% air tested underwater at 100 psi Open and Close positions.

BILL OF MATERIALS:

ITEM	NAME	T80SS	T80CS	QTY.
1	BODY	ASTM A351 GR. CF8M	ASTM A216 GR. WCB	1
2	END CAP	ASTM A351 GR. CF8M	ASTM A216 GR. WCB	1
3	BALL	ASTM A276 TYPE316	ASTM A276 TYPE316	1
4	SEAT	RPTFE	RPTFE	2
5	BODY SEAL	PTFE	PTFE	1
6	STEM	ASTM A276 TYPE316	ASTM A276 TYPE316	1
7	THRUST WASHER	RPTFE	RPTFE	1
8	STEM PACKING	RPTFE	RPTFE	2
9	GLAND NUT	ASTM A492 TYPE304	CARBON STEEL	1
10	HANDLE	ASTM A167 TYPE304	CARBON STEEL	1
11	LOCKING DEVICE	ASTM A167 TYPE304	CARBON STEEL	1
12	LEVER SLEEVE	VINYL PLASTISOL	VINYL PLASTISOL	1
13	SPRING WASHER	ASTM A492 TYPE304	CARBON STEEL	1
14	NUT	ASTM A492 TYPE304	CARBON STEEL	1

Conforms to:
Federal Specification WW-V-35B
Type II, Class C. Style 3

Pipe Thread in accordance with
ANSI B2 NPT

Drilled and Tapped Actuator
Mounting Pad

PRESSURE AND TEMPERATURE DATA

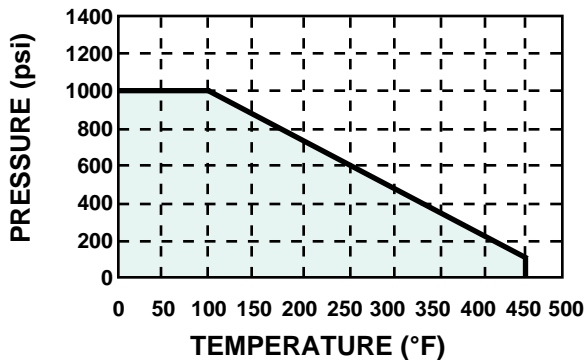

PRESSURE RATING: 1000 WOG

T80 For maximum
Flow Requirements

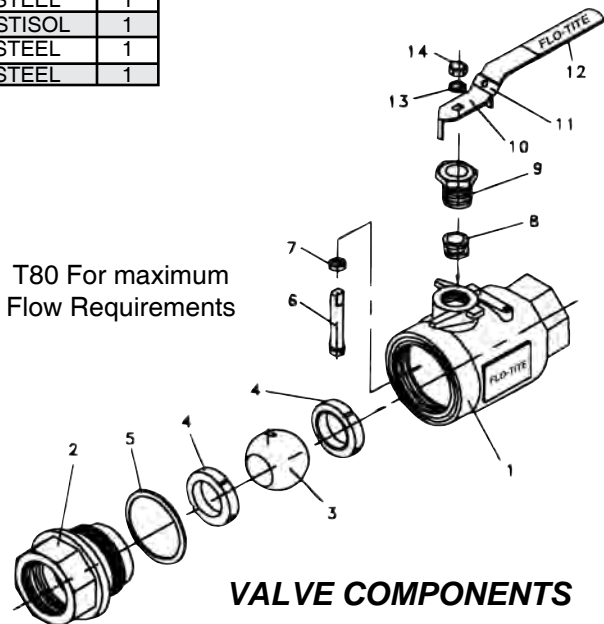

VALVE COMPONENTS